

Sliding Anchor Systems

A range of heavy duty (welded) and light duty (bent and/or twisted) stems. Available in standard stem lengths, head sizes and hole configurations with other options available on request. This range of products secure cavity walls to overhead structures, whilst accommodating vertical movement. Used in conjunction with one or two way sliding ties (ordered separately).

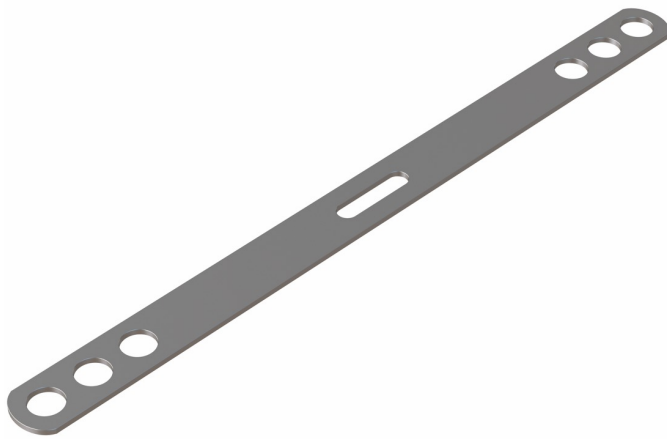

Product

SOW Sliding One Way Tie

SOW is designed to be used in conjunction with the sliding anchor stems. This tie 'catches' both the inner or the outer wall. Sizes are measured as the overall length of the tie.

Sizes: 200mm 250mm
225mm 300mm
230mm

Safety Precautions

STW Sliding TWO Way Ties are manufactured from sheared plate and strip and may contain sharp edges. Suitable personal protection should always be used when handling/installing these products.